

Fast Trak® - Standard

Pre-fabricated bracket solution offering speed, flexibility and efficient use of space, for the installation of electrical containment, pipework, ductwork and other mechanical services in restricted places.

- Quicker to install, up to six times faster than traditional suspension systems
- Safe pre-fabricated system which removes the need to cut threaded rod or channel on-site
- Tool free adjustment, bracket can be moved up and down the tracks to accommodate changes in position during installation
- Zero waste as tracks bend neatly under bracket*
- Versatile four-sided bracket provides suspension point on every face; ideal for installation of combined bracketry and multi-tiered configuration to accommodate additional services
- Easy measurement indicators at each end of the bracket offer measurement guide when marking fixing points on the ceiling; M4 level markers on the tracks highlight 50 mm increments, no leveling tools required
- Neat & tidy system can be 'stacked' on-site to reduce storage requirements



Installation & Adjustment

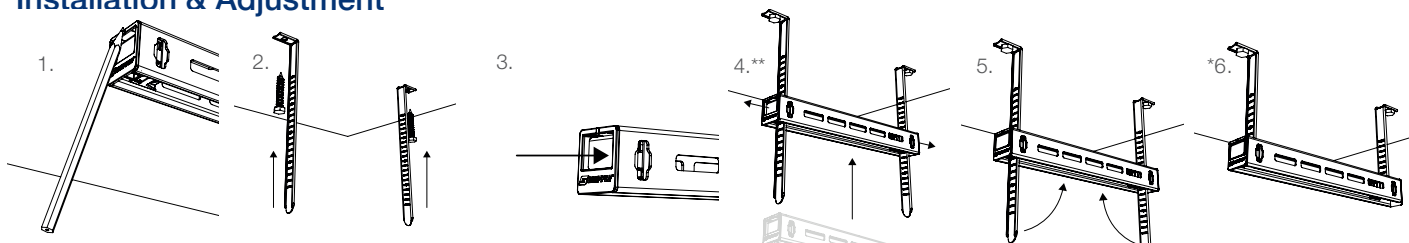

Internal applications only. Do not adjust under load. No dynamic loading. Single use only. **When installed correctly, button must be fully retracted and flush with the cartridge edge. *Excess tracks can also be snapped off once bracket is levelled & secured for a neater finish. Bending tracks by hand is not recommended when excess is under 100 mm.

Specifications

Bracket

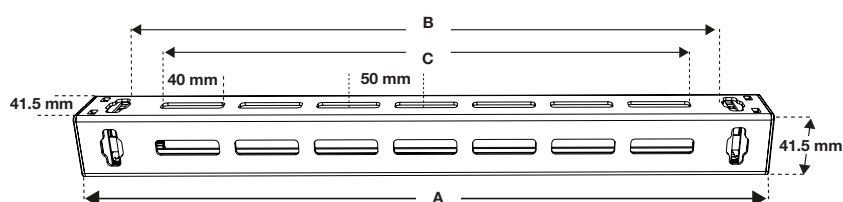

| Bracket | FTB-170 | FTB-270 | FTB-370 | FTB-470 | FTB-570 | FTB-670 | FTB-770 |
|-------------------------|---------|---------|---------|---------|---------|---------|---------|
| A (mm) Length | 239 | 339 | 439 | 539 | 639 | 739 | 839 |
| B (mm) Suspension Space | 176 | 276 | 376 | 476 | 576 | 676 | 776 |
| C (mm) Working Space | 140 | 240 | 340 | 440 | 540 | 640 | 740 |
| Number of Slots | 3 | 5 | 7 | 9 | 11 | 13 | 15 |

| Bracket | FTB-870 | FTB-970 | FTB-1070 | FTB-1170 | FTB-1270 | FTB-1370 | FTB-1470 |
|-------------------------|---------|---------|----------|----------|----------|----------|----------|
| A (mm) Length | 939 | 1039 | 1139 | 1239 | 1339 | 1439 | 1539 |
| B (mm) Suspension Space | 876 | 976 | 1076 | 1176 | 1276 | 1376 | 1476 |
| C (mm) Working Space | 840 | 940 | 1040 | 1140 | 1240 | 1340 | 1440 |
| Number of Slots | 17 | 19 | 21 | 23 | 25 | 27 | 29 |

Track

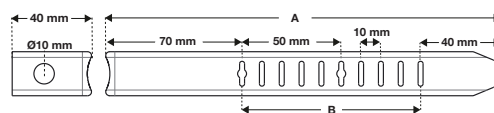

| Track | A (mm) | B (mm) |
|----------|--------|--------|
| FTT-200 | 200 | 90 |
| FTT-300 | 300 | 190 |
| FTT-400 | 400 | 290 |
| FTT-500 | 500 | 390 |
| FTT-600 | 600 | 490 |
| FTT-700 | 700 | 590 |
| FTT-800 | 800 | 690 |
| FTT-900 | 900 | 790 |
| FTT-1000 | 1000 | 890 |
| FTT-1100 | 1100 | 990 |
| FTT-1200 | 1200 | 1090 |
| FTT-1300 | 1300 | 1190 |
| FTT-1400 | 1400 | 1290 |
| FTT-1500 | 1500 | 1390 |
| FTT-2000 | 2000 | 1890 |
| FTT-2500 | 2500 | 2390 |

Submittal Information

Material:

Track & Bracket Material –

BS EN 10346:2009 DX51D (Mild Steel, Pre-Galv Z275)

Cartridge Housing – ABS Plastic

Spring – BS 2056 Austenitic 302S26 G2

Latch – EN 10346 S450GD

Safe Working Load: System rating: Up to 200 kg @ 3:1

Approvals:

Lloyds certified

UL tested

TÜV tested

APAVE tested



Fast Trak[®] - Standard

Maximum Working Load (kg/kN)*

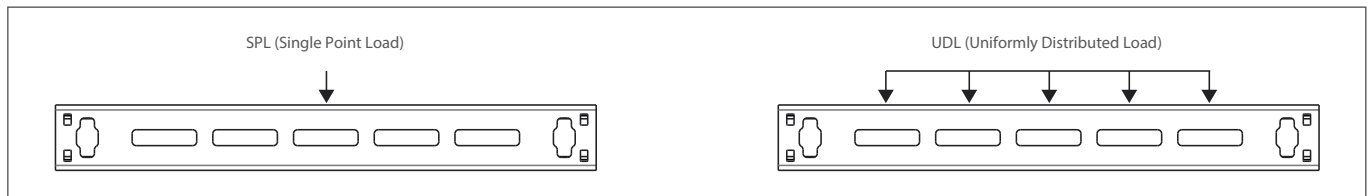

FTB-270 to FTB-1370

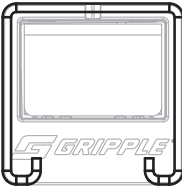
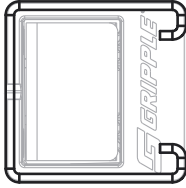
| Bracket Orientation | 'n' orientation | | 'c' orientation | |
|--|---|---------|---|---------|
| |  | |  | |
| Single Point Load (SPL) @ 3:1 | 100 kg | 0.98 kN | 70 kg | 0.68 kN |
| Uniformly Distributed Load (UDL) @ 3:1 | 200 kg | 1.96 kN | 130 kg | 1.27 kN |

FTB-1470

| | | | | |
|--|--------|---------|--------|---------|
| Single Point Load (SPL) @ 3:1 | 100 kg | 0.98 kN | 70 kg | 0.68 kN |
| Uniformly Distributed Load (UDL) @ 3:1 | 175 kg | 1.71 kN | 130 kg | 1.27 kN |

*For more details on specified loads or additional deflection ratings please contact Gripple Technical Services.
When loading multiple faces the total load applied must not exceed the values stated.

